

### Case Sealer Conversion

Change your old tape sealer and integrate a new glue sealer into your case packer. Glue doesn't have to be changed as often as tape and is much more reliable.

- Less Refilling - (operators add glue "on the fly")
- Corrugate savings with smaller KDF flaps
- Eco-friendly (uses less raw material)

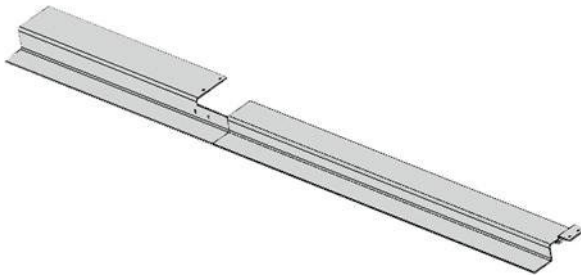

### Linear Rail Glue Shield

Have an engineered shield cover your critical dispenser linear bearing rail. Dripping glue on your linear rail of your case dispenser can destroy your linear bearings and spell disaster for production.

- Decreases downtime from broken bearings on case dispenser due to glue

### Machine Assembly Rebuilds

Have your high demand equipment brought back to "as new" factory specifications with original or current generation machine designs.

- decreased production downtime
- Increased machine reliability

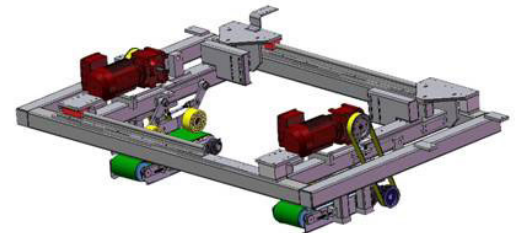

### Rotary Pneumatic Flap Tuckers

Directly replaces old style of linear actuated flap tuckers. These assemblies contain less moving and "wear" parts and have a demonstrated longer MTBF. This reliable and simple assembly comes with mounting plates and hardware to bolt right on.

**\$1,500 USD EACH**

### Venturi Vacuum Conversion Kit

Having vacuum pump problems? (Noisy, continuous operation, potential for vacuum leaks, high maintenance) Switch to simple venturi vacuum transducers. Just replace the entire unit to get your line back up and running. Venturi vacuum transducers are quiet, operate on demand (not continuous), create vacuum where the demand is required, and are less expensive to operate.

|   |                             |
|---|-----------------------------|
|   | <b>SAFETY</b>               |
| ✓ | <b>PERFORMANCE</b>          |
| ✓ | <b>RELIABILITY</b>          |
|   | <b>ENERGY EFFICIENCY</b>    |
| ✓ | <b>OPERATOR CONVENIENCE</b> |

Watch machinery video at <http://edson.com/video>