

Sure-Fit Change Parts Your Choice – Fixed or Adjustable Tooling

HighSpeed & Ergonomic Cassettes

Take any existing cassette and split the shelves into two. This allows the cassette to drop while the pusher arm is engaged with the product, to decrease cycle time. Each cassette side is now only half the weight of an entire cassette making for easier operator changing.

- Increased packer speed by up to 10%
- Better operator ergonomics
- Available with horizontal adjustability

From \$3,550 USD

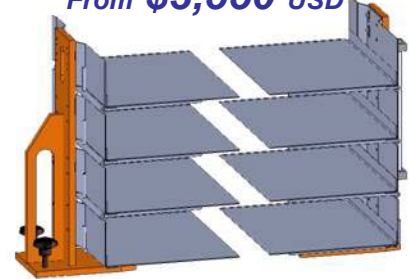

From \$1,750 USD

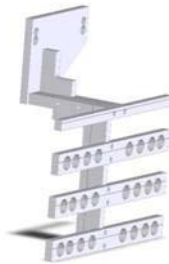

Product Pusher Arms

Made of a welded aluminum tube frame, these pusher arms allow faster packer speeds by allowing a high-speed cassette to lower sooner than older designs.

- Increased speed
- Faster and easier changeover.
- Available with horizontal adjustability

Adjustable Parts vs. Change Parts

Never lose your change parts again. Save time, money and aggravation by making a simple *adjustment* versus using an entirely new change part.

- No lifting of heavy change-parts
- Improved ergonomics
- Changeover time is reduced
- Dispenser Paddles, cassettes and pusher-arms

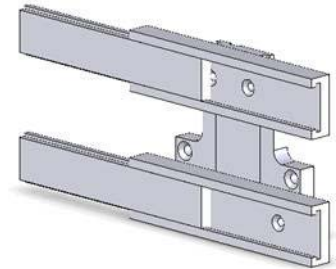

Pusher Plate

From \$650
USD

A product specific plate that fits onto the end of a pusher arm

Hot-Melt Compression Plates

From \$800
USD

Product specific plates that fit onto the end of the compression rams

Lifter Plate

From \$1,500
USD

Product specific plate that fits onto the end of the lifter cylinder

Product Shoe

From \$450
USD

Product specific plate that holds down product before the lifter cylinder

	SAFETY
✓	PERFORMANCE
✓	RELIABILITY
	ENERGY EFFICIENCY
✓	OPERATOR CONVENIENCE

Watch machinery video at <http://edson.com/video>